

RE12 (A916)

PARTS CATALOG

INTRODUCTION

This chapter instructs you the numbers and names of these parts on this machine.

INDEX to PARTS CATALOG

1. EDITOR BOARD (A916)	2
2. DECAL AND DOCUMENT (A916)	4
Parts Index	6

1. EDITOR BOARD (A916)

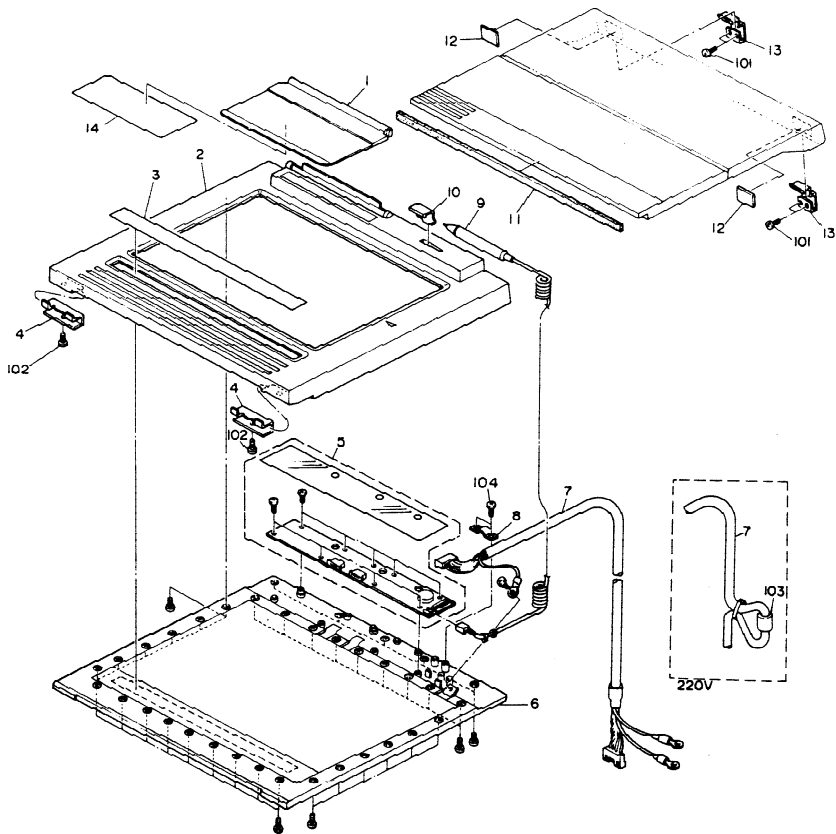

1. EDITOR BOARD (A916)

Index No.	Part No.	Description	Q'ty per Assembly
1	A916 1016	Original Cover - LT	1
1	A916 1015	Original Cover - A4	1
2	A916 1002	Upper Cover	1
3	A916 5141	Operation Sheet - LT	1
3	A916 5142	Operation Sheet - A4	1
4	A916 1051	Front Stopper	1
5	A916 5100	Main Control Board	1
6	A916 1006	Lower Cover - LT	1
6	A916 1007	Lower Cover - A4 MB3 (Added)	1
7	A916 5126	Editor Harness - 115V	1
	A916 5123	x/o,MB3	1
7	A916 5127	Editor Harness - 220/240V	1
	A916 5122	x/o,MB3	1
7	A916 5120	Editor Harness x/o,MB2	1
8	A916 5125	Harness Stopper MB3 (Added)	1
9	A916 5110	Pen	1
10	A916 1030	Pen Holder	1
11	A946 1058	Cushion - 513x22x15	1
	A946 1054	x/o,MB4	1
12	A916 1053	Support Stopper	1
13	A916 1052	Rear Stopper	1
14	A916 1023	Decal - Operating Guide - LT	1
14	A916 1022	Decal - Operating Guide - A4	1
14	A916 1024	Decal - 4 Languages MB1 (Added)	1

Index No.	Part No.	Description	Q'ty per Assembly
101	0434 0060W	Tapping Screw - M4x6	
102	0802 5094	Tapping Truss Head Screw - M4x8	
103	1607 0366	Ferrite Core	
104	0802 5136	Tapping Screw - M2.6x6 MB3 (Added)	

Operating Guide

1



Center the original (face up) on the right scale of the editor.

2



Touch keys) by using stylus. (EX.) Delete Area

3

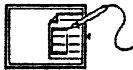

Enter editing points in diagonal direction by using stylus.

4



Place original on exposure glass.

5



Enter copy quantity and press "Start" key

Designate the area for the following modes by using the same procedure. Delete Area/Save Area/Black in Area/Color in Area/Highlight Color
■ Please refer to Operating Manual for other modes and details.



2. DECAL AND DOCUMENT (A916)

Index No.	Part No.	Description	Q'ty per Assembly
1	A916 1023	Decal - Operating Guide - LT	1
1	A916 1022	Decal - Operating Guide - A4	1
1	A916 1024	Decal - 4 Languages MB1 (Added)	1
2	A916 8600	Operating Instructions - English	1
2	A916 8605	Operating Instructions - 5 Language	1
3	A916 8610	Installation Procedure - English	1
3	A916 8615	Installation Procedure - 5 Language	1

Index No.	Part No.	Description	Q'ty per Assembly
-----------	----------	-------------	-------------------

PARTS INDEX

Part No.	Description	Paper and Index No.
A916 1002	Upper Cover	3- 2
A916 1006	Lower Cover - LT	3- 6
A916 1007	Lower Cover - A4 MB3 (Added)	3- 6
A916 1015	Original Cover - A4	3- 1
A916 1016	Original Cover - LT	3- 1
A916 1022	Decal - Operating Guide - A4	3-14
A916 1022	Decal - Operating Guide - A4	5- 1
A916 1023	Decal - Operating Guide - LT	3-14
A916 1023	Decal - Operating Guide - LT	5- 1
A916 1024	Decal - 4 Languages MB1 (Added)	3-14
A916 1024	Decal - 4 Languages MB1 (Added)	5- 1
A916 1030	Pen Holder	3-10
A916 1051	Front Stopper	3- 4
A916 1052	Rear Stopper	3-13
A916 1053	Support Stopper	3-12
A916 5100	Main Control Board	3- 5
A916 5110	Pen	3- 9
A916 5120	Editor Harness x/o,MB2	3- 7
A916 5122	x/o,MB3	3- 7
A916 5123	x/o,MB3	3- 7
A916 5125	Harness Stopper MB3 (Added)	3- 8
A916 5126	Editor Harness - 115V	3- 7
A916 5127	Editor Harness - 220/240V	3- 7
A916 5141	Operation Sheet - LT	3- 3
A916 5142	Operation Sheet - A4	3- 3
A916 8600	Operating Instructions - English	5- 2
A916 8605	Operating Instructions - 5 Language	5- 2
A916 8610	Installation Procedure - English	5- 3
A916 8615	Installation Procedure - 5 Language	5- 3
A946 1054	x/o,MB4	3-11
A946 1058	Cushion - 513x22x15	3-11

Part No.	Description	Paper and Index No.
0434 0060W	Tapping Screw - M4x6	3-101
0802 5094	Tapping Truss Head Screw - M4x8	3-102
0802 5136	Tapping Screw - M2.6x6 MB3 (Added)	3-104
1607 0366	Ferrite Core	3-103